

# Quickstart RW-9 Right Winder

RW-9 Right Winder is called right winder because the dancer arm is on the right side of the winder. RW-9 is normally used as a rewinder and therefore is placed in front of the LX2000e.

## Whats in the box?

- RW-9 Right Winder (dancer arm on the right)
- Power Supply



\* Images and colours can slightly difference compared to the original colours.

## Unboxing of RW-9

The RW-9 will be shipped in the padded box. Open the box and lift the RW-9 out of the box.

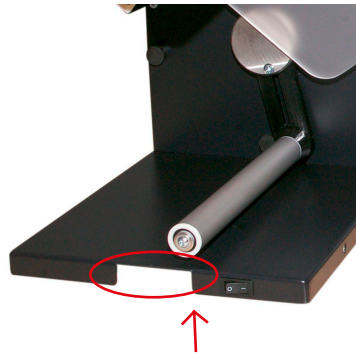

To lift it only use the gaps at the front and back. Do not lift it by grabbing the core holder or dancer arm as both can twist due to the weight of the winder.

## Installation of RW-9

Place the RW-9 Right Winder in front of the LX2000e Color Label Printer (or the label printer you prefer) and make sure it is at least 30cm away from the printer.

If you are using both winders, RW-9 and LW-9, make sure the LX2000e Color Label Printer is between both winders.

Then plug in the power supply and, if you're ready to operate, turn the winder on. Use the power switch at the front to do so.



**RW-9**  
RIGHT WINDER



**LX2000e**  
COLOR LABEL PRINTER



**LW-9**  
LEFT WINDER

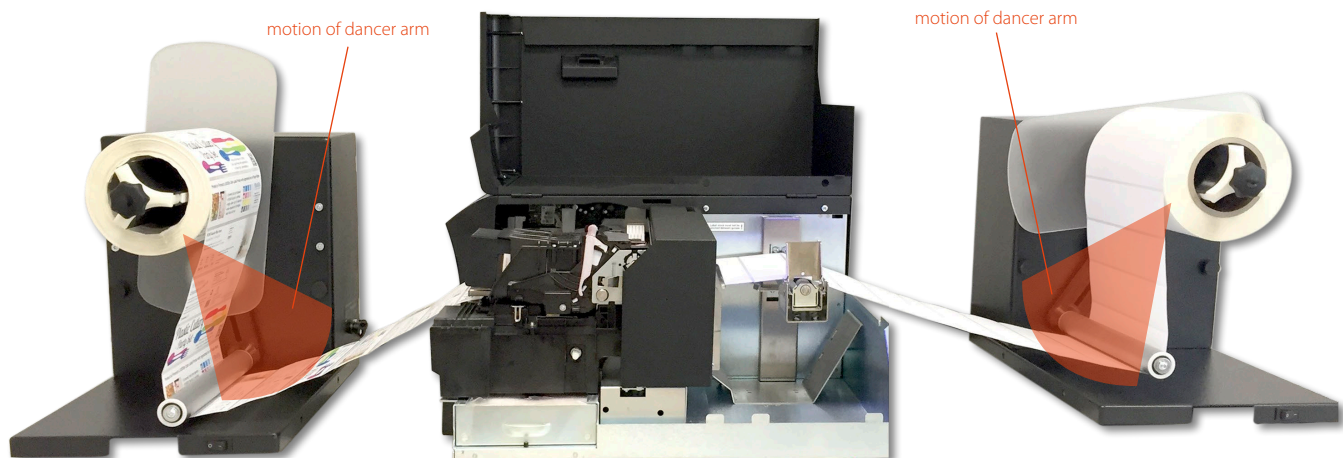

**NOTE:** We recommend to keep the box if the winder needs to be shipped or moved.

DTM Print GmbH  
Mainzer Strasse 131  
65187 Wiesbaden  
Germany  
support@dtm-print.eu  
dtm-print.eu